

# Dell™ Docking Station - USB 3.0

D3100

## Quick Start Guide



**1**  **NOTE:** Install the drivers first before connecting the Docking Station to your computer.

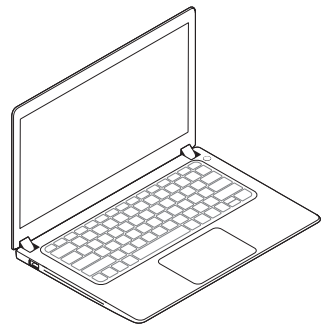

Driver download links:

- [dell.com/support](http://dell.com/support)
- [displaylink.com/downloads](http://displaylink.com/downloads)

Corporate installation software package:

[displaylink.com/corporateinstall](http://displaylink.com/corporateinstall)

**2**

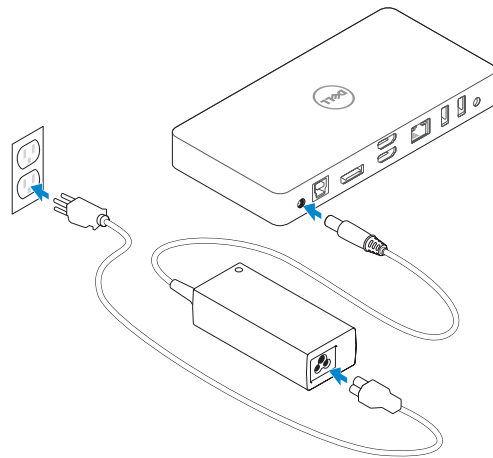

**3**

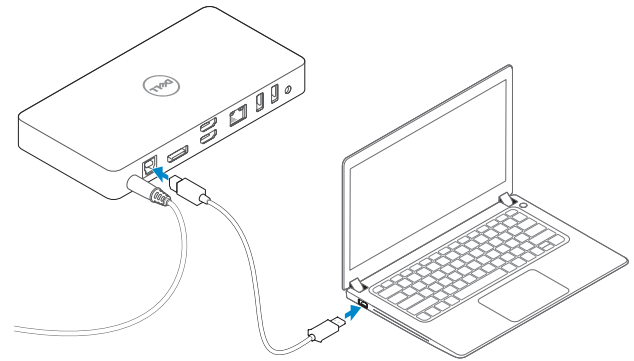

**4**

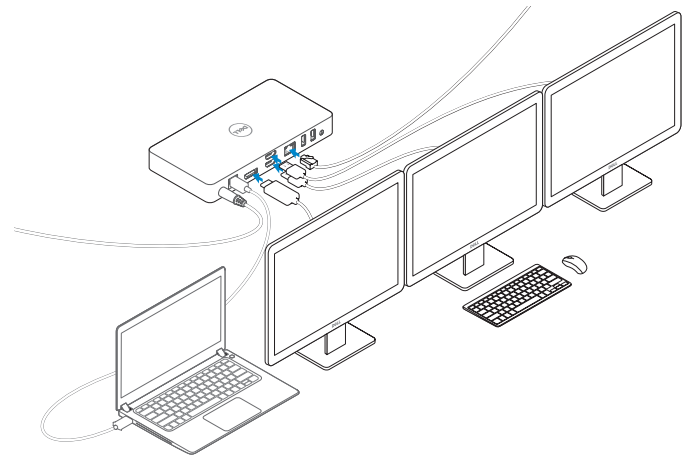

## Features

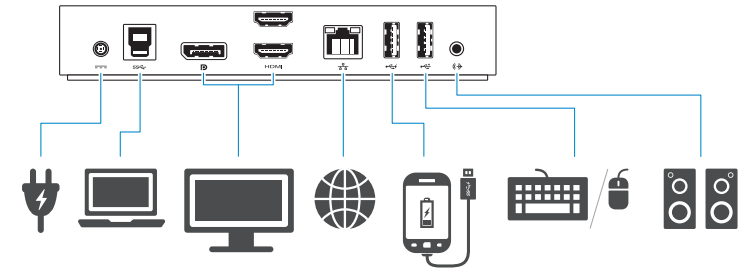
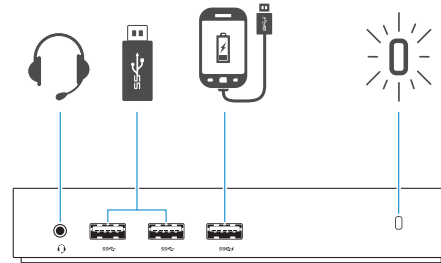

[dell.com/support](http://dell.com/support)  
[dell.com/contactdell](http://dell.com/contactdell)  
[dell.com/regulatory\\_compliance](http://dell.com/regulatory_compliance)

Regulatory model : **D3100**



026MCHA03



Printed in China.  
2017-01

- NOTE: For more information, see User's Guide at [dell.com/support](http://dell.com/support)
- NOTE: The latest drivers update can be downloaded from the DisplayLink support website at [displaylink.com/support](http://displaylink.com/support)
- NOTE: For network/IT administrators, please visit this link for a corporate installation software package. (\*User registration required)  
[displaylink.com/corporateinstall](http://displaylink.com/corporateinstall)